



Galbraith Street, London, E14 3LP

Asking price £230,000



Galbraith Street, London, E14 3LP

Asking price £230,000

*** NO ONWARD CHAIN ***

Nestled in the vibrant heart of London, this charming Studio flat on Galbraith Street offers a perfect blend of comfort and convenience.

Situated in a lively neighbourhood, residents will benefit from easy access to local amenities, including shops, cafes, and parks. Excellent transport links ensure that the rest of London is just a short journey away, making this flat an ideal base for those who wish to explore the city.

This property presents a wonderful opportunity for first-time buyers or investors looking to enter the London property market. With its prime location and practical design, this flat on Galbraith Street is not to be missed. Embrace the London lifestyle in this delightful home that combines comfort, convenience, and charm.

Key Features

- Large Studio Flat
- Moments Away from Cross Harbour DLR Station
- Walking Distance to Canary Wharf
- Great Buy to Let investment or First time buyer
- Lease can be extended
- Full Size Bathroom
- Large Kitchen



Council Tax Band: B

Floor Plans

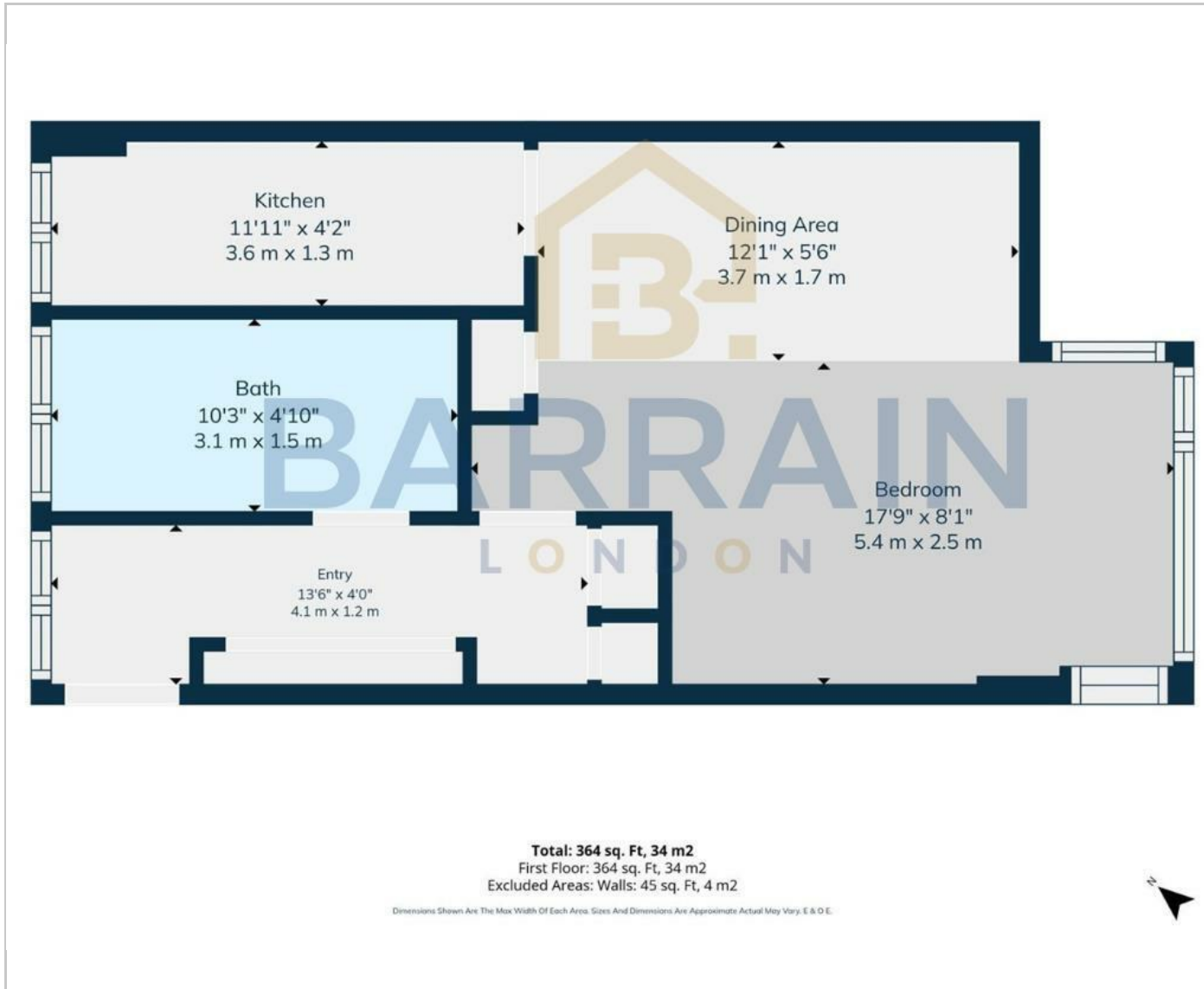

Area Map



Energy Performance Graph

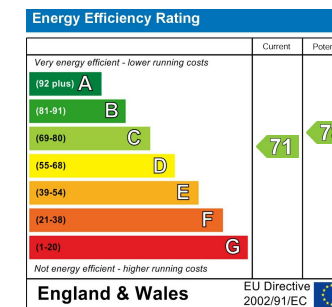

These particulars, whilst believed to be accurate are set out as a general outline only for guidance and do not constitute any part of an offer or contract. Intending purchasers should not rely on them as statements of representation of fact, but must satisfy themselves by inspection or otherwise as to their accuracy. No person in this firm's employment has the authority to make or give any representation or warranty in respect of the property.